

1  
A1 **FIRST FLOOR PLAN**  
FIRST FLOOR AREA: 3612 SQ. FT.  
SCALE: 1/4"=1'-0"

**Preliminary Plan Design**  
For Client review only; Not for Construction  
Amorin Ink Incorporated  
©2019 Thomas P. Amorin

CUSTOMER SIGNATURE: \_\_\_\_\_ DATE: \_\_\_\_\_  
CONTRACTOR SIGNATURE: \_\_\_\_\_ DATE: \_\_\_\_\_

REVISION LEVEL: \_\_\_\_\_  
DRAWN BY: THOMAS P. AMORIN START DATE: SEPTEMBER 19, 2018  
REVISION LEVEL: \_\_\_\_\_  
RELEASE DATE: C:\AD\GAM-BENNER\FLRPLAN 1-18-119 9:43:14 am EST

CONTRACTOR:  
**MATHEW BENNER**  
PROJECT MANAGER  
PHONE (443) 253-2322

PROJECT:  
**321 NORTH ADAMS STREET**  
STREET BUSINESS CENTER  
HAYNE DE GRACE, MD  
21078; HARFORD COUNTY

**AMORIN INK INCORPORATED**  
P.O. BOX 589, RISING SUN, MD 21157  
MAYNARD, MD 21113  
DR. CONTACT: E-MAIL: INFO@AMORININK.COM

SCALE:  
1/4"=1'-0"  
SHT. 1 OF 3  
PLAN NO. #  
018-040  
Y1M0

THE GENERAL CONTRACTOR SHALL BE RESPONSIBLE FOR OBTAINING ALL NECESSARY PERMITS AND APPROVALS FROM THE LOCAL, STATE AND FEDERAL AGENCIES. THE CONTRACTOR SHALL BE RESPONSIBLE FOR OBTAINING ALL NECESSARY PERMITS AND APPROVALS FROM THE LOCAL, STATE AND FEDERAL AGENCIES. THE CONTRACTOR SHALL BE RESPONSIBLE FOR OBTAINING ALL NECESSARY PERMITS AND APPROVALS FROM THE LOCAL, STATE AND FEDERAL AGENCIES.



1  
A2 FRONT ELEVATION  
SCALE: 1/4"=1'-0"

Account Identifier: District - 06 Account Number - 029876		
Owner Information		
Owner Name: BENNER MATTHEW	Use: COMMERCIAL	
Mailing Address: 1489 BELVEDERE RD PORT DEPOSIT MD 21904-1534	Principal Residence: NO Deed Reference: /12523/ 00160	
Location & Structure Information		
Premises Address: 321 N ADAMS ST HAVRE DE GRACE 21078-2801	Legal Description: LOT 100X50 321 N ADAMS STREET HAVRE DE GRACE	
Map: 0501 0000 0614	Sub District: 0000	
Grid: 0000	Subdivision: 214	
Parcel: 0614	Section: 214	
Block: 214	Lot: 2019	
Assessment Year: 2019	Plat No: 0000	
Special Tax Areas:	Town: HAVRE DE GRACE	
	Ad Valorem:	
	Tax Class:	
Primary Structure Built: 1900	Above Grade Living Area: 4924	
Finished Basement Area:	Property Land Area: 5,000 SF	
County Use:		
Stories:	Basement:	
Type:	Exterior:	
Full/Half Bath:	Garage:	
Last Major Renovation:		
Value Information		
Base Value:	Value:	
As of 01/01/2019:	As of 07/01/2018:	
Phase-in Assessments:	As of 07/01/2019:	
Land: 93,000	Improvements: 282,600	
Total: 375,600	Preferential Land: 0	
Transfer Information		
Seller: BENNER J KENNETH	Date: 09/22/2017	Price: \$0
Type: NON-ARMS LENGTH OTHER	Deed1: /12523/ 00160	Deed2:
Seller: FENNER FRANKLIN V	Date: 11/17/1993	Price: \$210,000
Type: NON-ARMS LENGTH OTHER	Deed1: /02038/ 00153	Deed2:
Seller: SAUNDERS ANGELA I INC	Date: 05/17/1984	Price: \$55,000
Type: NON-ARMS LENGTH OTHER	Deed1: /01226/ 00881	Deed2:

2  
A2 PROPERTY ASSESMENT  
321 NORTH ADAMS STREET,  
HAVRE DE GRACE MD. 21075

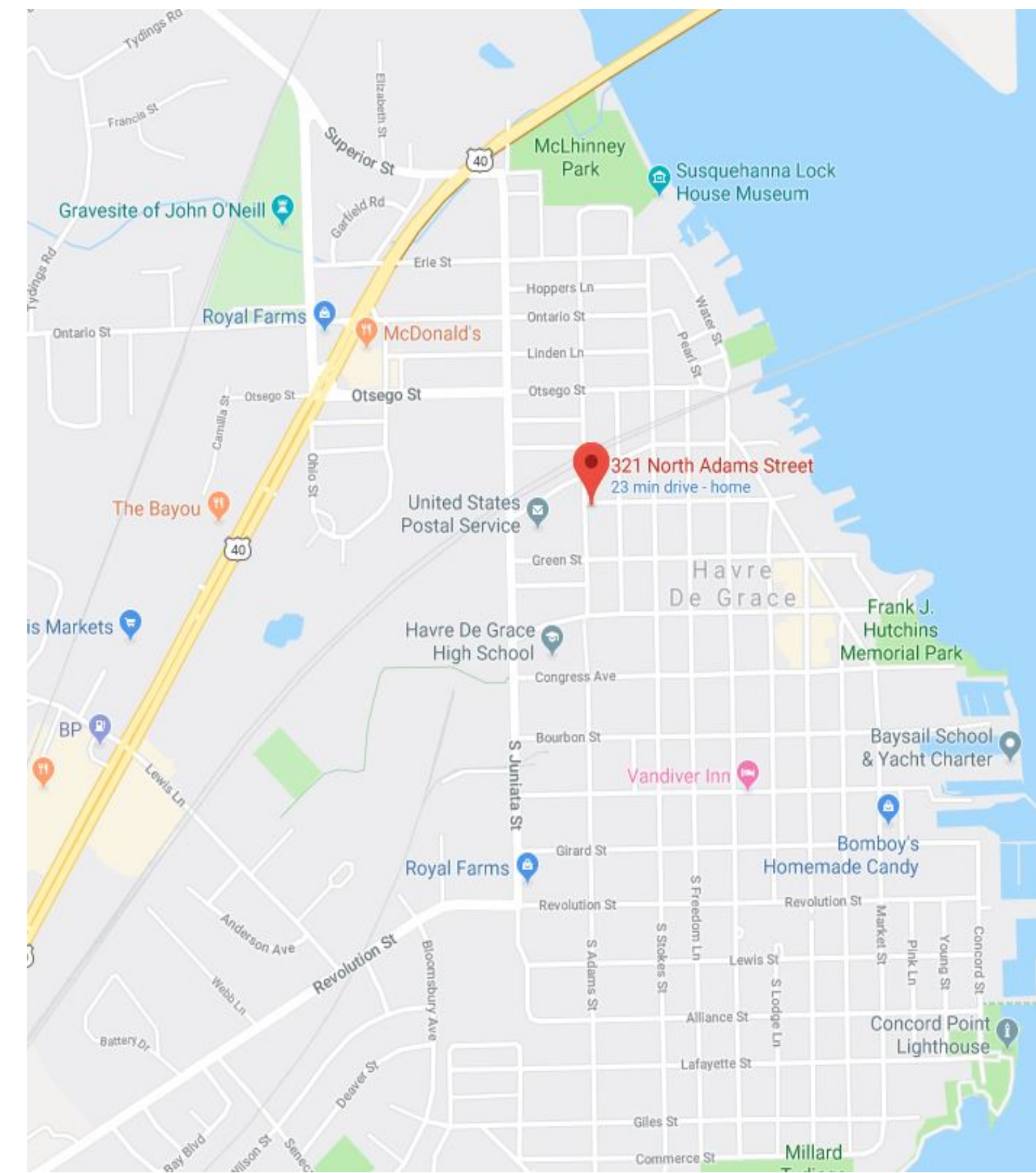

3  
A2 PROJECT SITE LOCATION  
321 NORTH ADAMS STREET,  
HAVRE DE GRACE MD. 21075



4  
A2 LEFT SIDE ELEVATION  
SCALE: 1/4"=1'-0"

CUSTOMER SIGNATURE: \_\_\_\_\_ DATE: \_\_\_\_\_  
CONTRACTOR SIGNATURE: \_\_\_\_\_ DATE: \_\_\_\_\_

THE GENERAL CONTRACTOR SHALL BE RESPONSIBLE FOR OBTAINING ALL NECESSARY PERMITS AND APPROVALS FROM THE LOCAL, STATE AND FEDERAL AGENCIES. THE CONTRACTOR SHALL BE RESPONSIBLE FOR OBTAINING ALL NECESSARY PERMITS AND APPROVALS FROM THE LOCAL, STATE AND FEDERAL AGENCIES. THE CONTRACTOR SHALL BE RESPONSIBLE FOR OBTAINING ALL NECESSARY PERMITS AND APPROVALS FROM THE LOCAL, STATE AND FEDERAL AGENCIES. THE CONTRACTOR SHALL BE RESPONSIBLE FOR OBTAINING ALL NECESSARY PERMITS AND APPROVALS FROM THE LOCAL, STATE AND FEDERAL AGENCIES.

REVISION LEVEL: \_\_\_\_\_  
DRAWN BY: THOMAS P. AMORIN START DATE: SEPTEMBER 19, 2018  
REVISION LEVEL: \_\_\_\_\_  
RELEASE DATE: C:\AD\GAM-BENNER\BELEVATE 1-18-19 9:44:07 am EST

CONTRACTOR: MATHIEW BENNER  
PROJECT MANAGER  
PHONE (443) 253-2322

PROJECT: 321 NORTH ADAMS STREET  
BUSINESS CENTER  
HAVRE DE GRACE, MD  
21078; HARFORD COUNTY

AMORIN INK INCORPORATED  
P.O. BOX 5896 RISING SUN 21157-0896  
MAY 11 2019 10:59 AM  
VISIT US ONLINE AT WWW.AMORININK.COM  
OR CONTACT E-MAIL INFO@AMORININK.COM

SCALE: 1/4"=1'-0"  
SHT. 2 OF 3  
PLAN NO#: 018-040  
Y1M0

**Preliminary Plan Design**  
For Client review only; Not for Construction  
Amorin Ink Incorporated  
©2019 Thomas P. Amorin

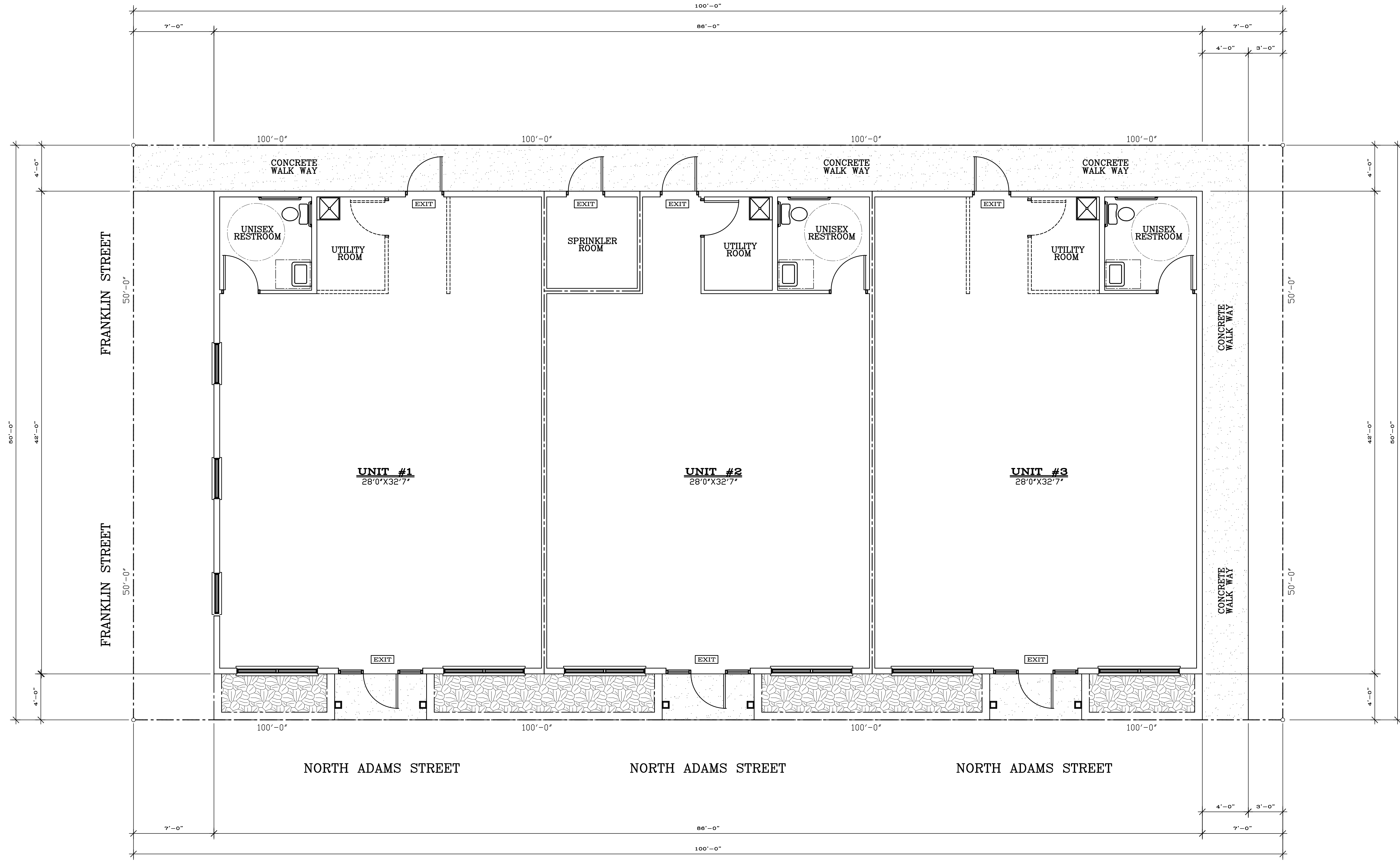

**1**  
A3 **PLOT PLAN SCHEMATIC**  
SCALE: .25"=1'-0"

CUSTOMER SIGNATURE: \_\_\_\_\_ DATE: \_\_\_\_\_  
 CONTRACTOR SIGNATURE: \_\_\_\_\_ DATE: \_\_\_\_\_

THE GENERAL CONTRACTOR SHALL BE RESPONSIBLE FOR OBTAINING ALL NECESSARY PERMITS AND DISPERSES TO BE BROUGHT TO THE IMMEDIATE ATTENTION OF THE CLIENT. THE CONTRACTOR SHALL BE RESPONSIBLE FOR OBTAINING ALL NECESSARY PERMITS AND DISPERSES TO BE BROUGHT TO THE IMMEDIATE ATTENTION OF THE CLIENT. THE CONTRACTOR SHALL BE RESPONSIBLE FOR OBTAINING ALL NECESSARY PERMITS AND DISPERSES TO BE BROUGHT TO THE IMMEDIATE ATTENTION OF THE CLIENT.

REVISION LEVEL: \_\_\_\_\_  
 REVISION LEVEL: \_\_\_\_\_

DRAWN BY: THOMAS P. AMORIN START DATE: SEPTEMBER 19, 2018  
 REVISION LEVEL: \_\_\_\_\_  
 RELEASE DATE: C:\AD\GAM-BENNER\3PLD\PLN 9:54:59 am EST

CONTRACTOR: MATHIEW BENNER  
 PROJECT MANAGER  
 PHONE (443) 253-2322

PROJECT: 321 NORTH ADAMS STREET  
 BUSINESS CENTER  
 HAVRE DE GRACE, MD  
 21078; HARFORD COUNTY

**AMORIN INK INCORPORATED**  
 P.O. BOX 5896 RISING SUN 21091-7184  
 VISIT US ONLINE AT WWW.AMORININK.COM  
 OR CONTACT E-MAIL INFO@AMORININK.COM

SCALE: 1/4"=1'-0"  
 SHT. 3 OF 3  
 PLAN NO#: 018-040  
 Y1M0

**Preliminary Plan Design**  
 For Client review only; Not for Construction  
 Amorin Ink Incorporated  
 ©2019 Thomas P. Amorin